

# N8 SERIES SP8T DC - 18.0 GHz

## MOUNTING BRACKET

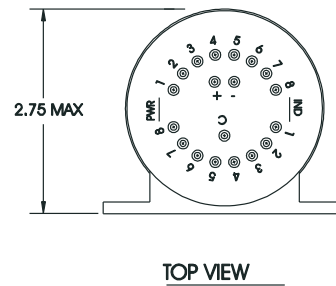

|  |          |           |           |            |             |
|--|----------|-----------|-----------|------------|-------------|
| <b>FREQUENCY:</b><br>GHz                                 | DC - 2.0 | 2.0 - 4.0 | 4.0 - 8.0 | 8.0 - 12.4 | 12.4 - 18.0 |
| <b>VSWR (MAX.)</b>                                       | 1.20:1   | 1.25:1    | 1.30:1    | 1.40:1     | 1.50:1      |
| <b>INSERTION LOSS (MAX.)</b>                             | 0.20     | 0.25      | 0.30      | 0.40       | 0.50        |
| <b>ISOLATION (MIN.)</b>                                  | 90       | 80        | 80        | 70         | 60          |
| <b>IMPEDANCE</b>   | 50 Ohms  |           |           |            |             |
| <b>MECHANICAL</b>  |          |           |           |            |             |
| CONTACT : BREAK BEFORE MAKE                              |          |           |           |            |             |
| ACTUATOR : FAILSAFE, LATCHING, MOMENTARY                 |          |           |           |            |             |
| SWITCHING SPEED : 20 mSEC MAX.                           |          |           |           |            |             |
| <b>ELECTRICAL</b>  |          |           |           |            |             |
| ACTUATOR VOLTAGE : 28.0, 24.0, 15.0 Vdc                  |          |           |           |            |             |
| ACTUATOR CURRENT : CONTACT CEI                           |          |           |           |            |             |
| POWER HANDLING : 200 WCW @ 1.0 GHz                       |          |           |           |            |             |
| 300 WCW @ 1.0 GHz (OPT. /P)                              |          |           |           |            |             |
| <b>ENVIRONMENTAL</b>                                     |          |           |           |            |             |
| OPERATING TEMP : -40 DEG. C TO 90 DEG. C (STANDARD)      |          |           |           |            |             |
| -54 DEG. C TO 90 DEG. C (OPT. /MS)                       |          |           |           |            |             |
| SINE VIBRATION : 20 G'S                                  |          |           |           |            |             |
| RANDOM VIBRATION : 15 G'S                                |          |           |           |            |             |
| LIFE : 1,000,000 CYCLES                                  |          |           |           |            |             |
| DESIGNED TO MEET MIL-S-3928 AND MIL-E-5400               |          |           |           |            |             |
| <b>FINISH</b>  |          |           |           |            |             |
| RF CAVITY : ALUMINUM ELECTROLESS NICKEL PLATED           |          |           |           |            |             |
| PER MIL-C-26074, CLASS 4                                 |          |           |           |            |             |
| (EXCEPT LOW OR ULTRA LOW PIM MODELS)                     |          |           |           |            |             |
| ENCLOSURE : ALUMINUM, BLUE OR BLACK                      |          |           |           |            |             |
| CONTACT : BERYLLIUM COPPER, GOLD PLATED                  |          |           |           |            |             |
| PER MIL-G-45204  |          |           |           |            |             |
| CONNECTOR SHELL : CRES, PASSIVATED PER QQ-P-35 OR BRASS, |          |           |           |            |             |
| ELECTROLESS NICKEL PLATED                                |          |           |           |            |             |
| PER MIL-C-26074  |          |           |           |            |             |
| <b>AVAILABLE OPTIONS</b>                                 |          |           |           |            |             |
| INDICATOR CIRCUITRY : CUT OFF POWER CIRCUIT              |          |           |           |            |             |
| SUPPRESSION DIODE : D' SUB MINIATURE SERIES              |          |           |           |            |             |
| TTL LOGIC : MS CONNECTOR (MIL-SPEC)                      |          |           |           |            |             |
| CUSTOM DESIGNS : LOW OR ULTRA LOW (PIM)                  |          |           |           |            |             |

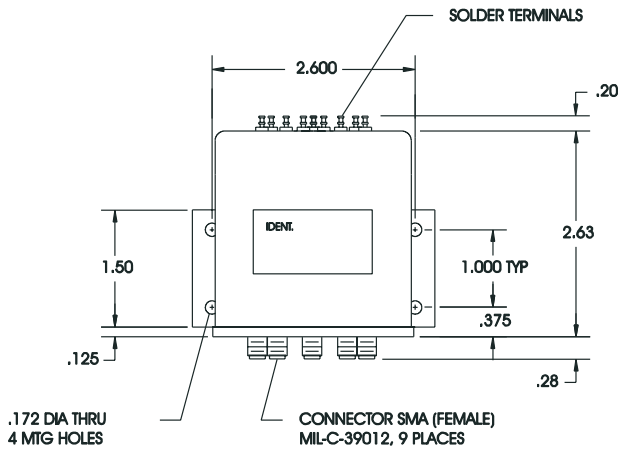

NOTE: SWITCH SHOWN WITH INDICATOR OPTION

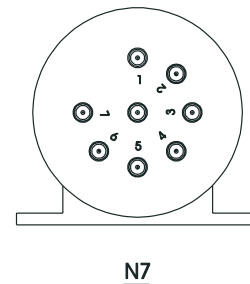
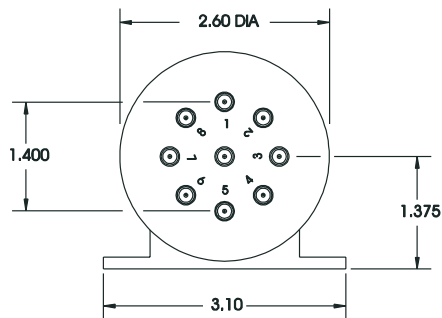

## N7-N8 SERIES PART NUMBER &amp; ORDERING INFORMATION

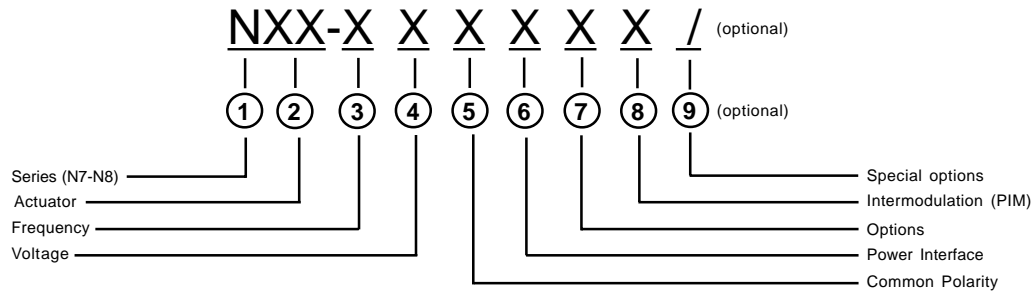
**1 - Switch Series**

|    |          |
|----|----------|
| N7 | SP7T SMA |
| N8 | SP8T SMA |

**2 - Actuator**

|   |   |   |  |
|---|---|---|--|
| F | FAILSAFE                                      | R | MOMENTARY                                      |
| G | FAILSAFE WITH SUPPRESSION DIODE               | S | MOMENTARY WITH SUPPRESSION DIODE               |
| H | FAILSAFE WITH INDICATOR                       | T | MOMENTARY WITH INDICATOR                       |
| J | FAILSAFE WITH SUPPRESSION DIODE AND INDICATOR | U | MOMENTARY WITH SUPPRESSION DIODE AND INDICATOR |
| L | LATCHING                                      | Y | OTHER (SPECIFY)                                |
| M | LATCHING WITH SUPPRESSION DIODE               |   |  |
| N | LATCHING WITH INDICATOR                       |   |  |
| P | LATCHING WITH SUPPRESSION DIODE AND INDICATOR |   |  |

**3 - Frequency Bandwidth**

|   |               |   |                 |
|---|---------------|---|-----------------|
| 1 | DC - 13.0 GHz | 6 | DC - 6.0 GHz    |
| 2 | DC - 2.0 GHz  | 8 | DC - 20.0 GHz   |
| 3 | DC - 12.4 GHz | 0 | OTHER (SPECIFY) |
| 4 | DC - 4.0 GHz  |   |                 |
| 5 | DC - 18.0 GHz |   |                 |

**4 - Voltage**

|   |                            |   |                            |
|---|----------------------------|---|----------------------------|
| 1 | 10 - 14 Vdc (12.0 NOMINAL) | 4 | 24 - 32 Vdc (28.0 NOMINAL) |
| 2 | 13 - 18 Vdc (15.0 NOMINAL) | 5 | OTHER                      |
| 3 | 20 - 30 Vdc (24.0 NOMINAL) | 0 | NOT REQUIRED               |

**5 - Common Polarity**

|   |                                   |
|---|-----------------------------------|
| 1 | POSITIVE (+) COMMON               |
| 2 | NEGATIVE (-) OR RETURN Vdc COMMON |
| 0 | NOT REQUIRED                      |

**6 - Power Interface**

|   |   |   |   |
|---|---|---|---|
| 1 | SOLDER TERMINAL (TOP OF SWITCH)               | 5 | D' SUB MINIATURE SERIES (TOP OF SWITCH) |
| 3 | CONN MS3112E-XX-XXP OR EQUIV. (TOP OF SWITCH) | 8 | OTHER                                   |

**7 - Options**

|   |   |   |                           |
|---|---|---|---------------------------|
| 1 | CUT OFF POWER CIRCUIT (LATCHING ONLY)           | 8 | OTHER (SPECIFY)           |
| 2 | TTL LOGIC                                       | 9 | CUSTOM (ORDER)            |
| 3 | CUT OFF PWR CIRCUIT & TTL LOGIC (LATCHING ONLY) | 0 | NO OTHER OPTIONS REQUIRED |

**8 - Intermodulation**

|   |                                  |   |                                   |
|---|----------------------------------|---|-----------------------------------|
| 7 | LOW PASSIVE INTERMODULATION      | 9 | ULTRA LOW PASSIVE INTERMODULATION |
| 8 | SUPERIOR PASSIVE INTERMODULATION | 0 | STANDARD SWITCH                   |

**9 - Special Options (optional - leave blank if not required)**

|      |   |
|------|---|
| /P   | HIGH TEMP, HIGH POWER CONNECTOR                         |
| /MS  | EXTENDED TEMP RANGE -54 DEG C TO + 90 DEG               |
| /MSP | HIGH TEMP, HIGH POWER CONNECTOR AND EXTENDED TEMP RANGE |